



# Thomsen Harbor Lift Station Rehabilitation

## Project Fact Sheet

The Thomsen Harbor Lift Station has been in operation since 1984 serving all residential and commercial sewage collection for the Baranof Island-side of Sitka. The system operates by receiving sewage and distributing it through force mains into the wastewater treatment plant on Japonski Island. The Lift Station functions around the clock, pumping an average of 1 million gallons of sewage per day. The Thomsen Harbor Lift Station Rehabilitation project will rehabilitate this critical piece of sewer infrastructure which is at the end of its useful life. The project includes construction of new under ground dry and wet vaults, new pumps, and installation of a new generator for the system. The project is being funded by Alaska Department of Environmental Conservation (ADEC) Loans and City & Borough of Sitka (CBS) Working Capital fund. The rehabilitation of the lift station will provide an efficient, effective, maintainable, and environmentally safe facility for decades to come.

### Schedule

(note these dates are subject to change)

- Project start – March 2024 (*Potholing, Utility Relocates, Equipment Staging.*)
- Construction Start—May 7, 2024
- Substantial Completion – October 2024

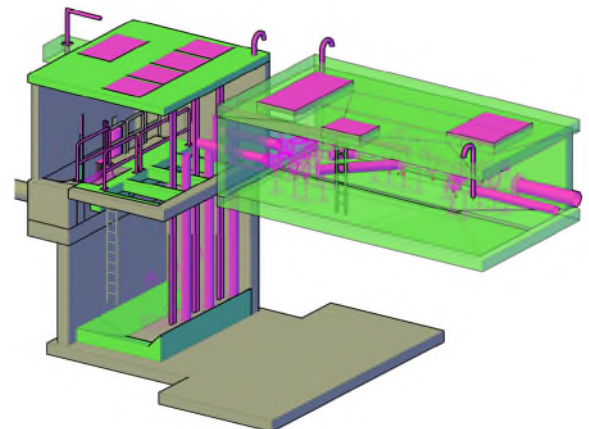

*Proposed Drawing of New Lift Station*

### Frequently Asked Questions

#### How will this impact me during Construction?

There are no planned disruptions to the sanitary sewer system during the time of the project. One lane of traffic into/out of Thomsen Harbor shall remain operational during construction to allow residents and business owners access to their property.

**If you have questions or want to learn more, contact:**

Shilo Williams - Environmental Superintendent  
Phone: 907-747-4071  
Email: [Shilo.williams@cityofsitka.org](mailto:Shilo.williams@cityofsitka.org)

Ron Vinson - Public Works Director  
Phone: 907-747-1804  
Email: [ron.vinson@cityofsitka.org](mailto:ron.vinson@cityofsitka.org)